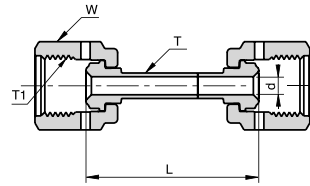
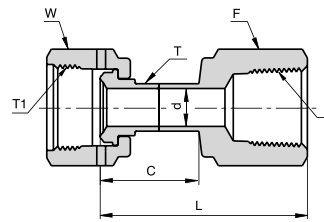

UFF

FEMALE TO FEMALE UNION

Ordering Information	Face Seal Size	L		d		W	T Tube O.D.	T1 Thread Size
	inch	mm	inch	mm	inch	inch	inch	inch
P-UFF-1/4 X 1/4	1/4	43.0	1.69	4.6	0.18	3/4	1/4	9/16 - 18
P-UFF-1/2 X 1/2	1/2	44.1	1.73	10.2	0.40	1 1/16	1/2	7/8 - 14

FCF

FEMALE TO FEMALE NPT CONNECTOR

Ordering Information	Face Seal Size	L		C		d		F	W	T Tube O.d.	T Thread Size	P NPT-F
	inch	mm	inch	mm	inch	mm	inch	inch	inch	inch	inch	inch
P-FCF-1/4 X 1/4	1/4	45.0	1.77	23.4	0.92	4.6	0.18	3/4	3/4	1/4	9/16 - 18	1/4
P-FCF-1/2 X 1/2	1/2	54.8	2.16	26.4	1.04	10.2	0.40	1 1/16	1 1/16	1/2	7/8 - 14	1/2

FHTL

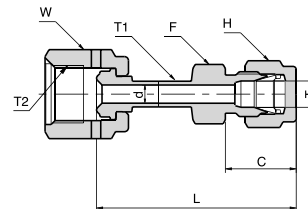
FEMALE TO LET-LOK CONNECTOR

Ordering Information	Face Seal Size	L		C		d		F	W	H	T Tube O.D.	T1 Tube O.D.	T2 Thread Size
	inch	mm	inch	mm	inch	mm	inch	inch	inch	inch	inch	inch	inch
P-FHTL-1/4 X 1/4	1/4	49.3	1.94	17.8	0.70	4.6	0.18	1/2	3/4	9/16	1/4	1/4	9/16 - 18
P-FHTL-1/2 X 1/2	1/2	56.6	2.23	21.8	0.86	10.2	0.40	13/16	1 1/16	7/8	1/2	1/2	7/8 - 14

Dimensions are for reference only, and are subject to change without notice.
When ordering, be sure to add the Surface-Finish Designator (either H or E) to the Part Number. (See Material Table, page 157).